

2008-MAY-09

Larry McNabb, Chair  
Parks, Recreation and Culture Commission

Dear Mr. McNabb:

**Re: Proposal for Phase Two of DIGS Community Garden Project**

Background: On May 31<sup>st</sup> last year, DIGS was given a \$15,000 grant by your Committee to proceed with Phase One of our plan for a community Garden on Protection Island.

For us, it has been a very successful year. To create the garden, we have built 15 raised beds; filled them with 30 yards of soil, driven and cemented in posts; stretched wire; moved sheds; created 2 arbors; painted and planted and made a garden of which we are very proud.

In the process we have made new friends; shared our tools and machinery; given freely of our time and fostered a wonderful sense of community. We have benefitted from some wonderful donations, including cash, machinery, a complete garden shed and even a greenhouse. Our latest initiative is a children's gardening programme, called "Little Diggers", which will run every Saturday from May until September. DIGS current membership is 64, Little Diggers membership is 11 and we like to think that we are not done yet. With your consent, we would like to proceed with Phase Two, which is outlined below.

**Proposal for Phase Two**

DIGS proposes extending our community garden eastward by 30' (see attached map). This would give us room for 8 new raised beds, a perimeter bed along the fence, and a greenhouse. DIGS proposes offering these 8 raised beds to the islanders as allotment beds, subject to the rules outlined in our garden guidelines. In the perimeter beds DIGS plan to create a heritage apple orchard using cuttings from island trees.

**Budget**

Initial Funding Allocation (2007)	\$15,000
Capital Expenses for Phase One (2007 and 2008) Excluding Water Installation	\$9,599.52
Proposed Capital Expenses for Phase Two (2008 and 2009)	\$5,031.03

\*See Appendix One

## **Summary**

With your support, DIGS members would start construction of Phase Two this fall, in the hopes of having it operational in the spring of 2009. We have been amazed at the extent of Community Support for the garden and think we have built a sound foundation from which to expand.

Yours truly,

Jim Harris, DIGS President

## APPENDIX #1

### Capital Costs (Parks, Recreation and Cultural Commission)

Beds	Perimeter beds 4"x4" - 660' @ 1.40'	924.00
	Raised beds 4x4 - 1680 @ 1.40'	2352.00
	Nails 6" 3 boxes @ 74.13 ea	222.39
	Soil 30 yds @ 24.50 yd + delivery @ 155.00	890.00
Fence	Corners 8x4"x4"x8' - 64' @ 1.40'	89.60
	Braces 6x4"x4"x8' - 48' @ 1.40'	67.20
	Metal Posts 9 @ 6.29	56.61
	Driver 1 Day @ 10.00	10.00
	Clips 1 box @ 4.49	4.49
	Concrete @ 2 per hole x 8 = 16 bags @ 8.50 ea	136.00
	Wire 1 roll (165') @ 170.99/roll	170.99
	Hardware – Lag screws 12 @ 0.71	8.52
	- Washers 12 @ 0.07	0.84
	- Brace wire 10 lbs @ 22.39	22.39
Barging	2 trips @ 500.00	1000.00
	TOTAL	5,031.03

### Labour Costs for Phase Two (Donated)

	Surveying and blackberry removal	8 hrs.
	Sod removal @ 4 hrs/bed	40 hrs.
	Building 8 beds (24' raised) 0.3 hrs/bed	24 hrs.
	Building 2 perimeter beds (104') @ 3 hrs/bed	12 hrs.
	Filling beds with soil @ 2 hrs/bed	24 hrs.
	Excavating corner post holes @ 0.5 hrs/post x 8	4 hrs.
	Siting and cementing corner posts @ 1 hr/post x 8	8 hrs.
	Bracing corner posts @ 1 hr/post	8 hrs.
	Stretching deer fencing & top wire	16 hrs.
	Moving greenhouse	8 hrs.
	TOTAL	160 hrs., @ 20.00/hr = 3,200.00

# Proposed Site Plan for DIGS Community Gardens

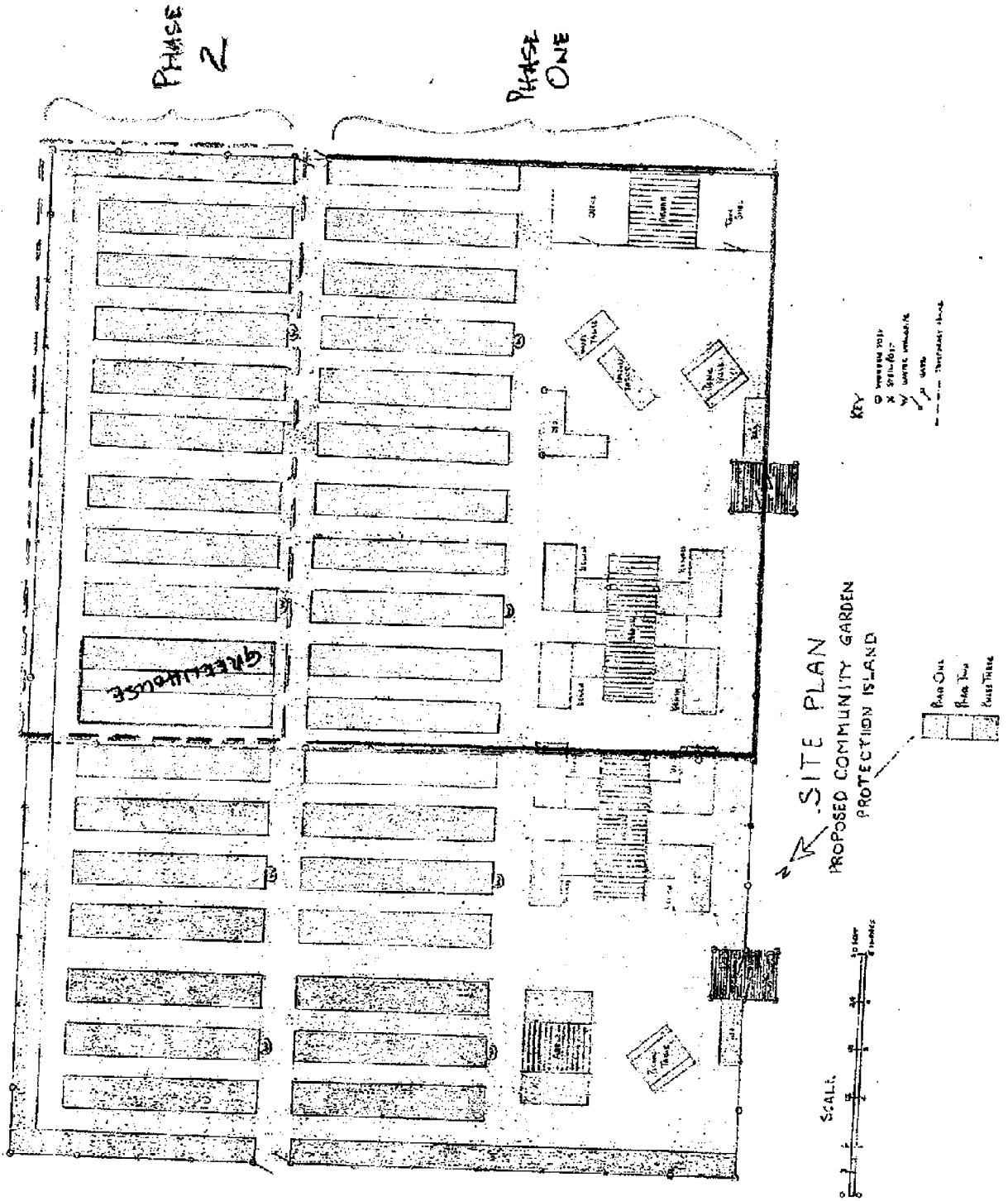

N ↑

BARBERSHIRE COURT